

Accessing file systems for linux machines on the local network

Locate the other machines on your local network:

```
sudo arp-scan --localnet
```

result example:

Interface: wlp0s20f3, type: EN10MB, MAC: 04:33:c2:71:7e:42, IPv4: 192.168.0.106

Starting arp-scan 1.9.7 with 256 hosts (<https://github.com/royhills/arp-scan>)

```
192.168.0.1   cc:32:e5:54:10:13   TP-LINK TECHNOLOGIES CO.,LTD.
192.168.0.105 f0:f0:a4:15:28:59   (Unknown)
192.168.0.113 18:a6:f7:1d:98:59   TP-LINK TECHNOLOGIES CO.,LTD.
192.168.0.181 00:0e:08:eb:76:d5   Cisco-Linksys, LLC
192.168.0.157 c0:e7:bf:09:b8:bd   (Unknown)
192.168.0.172 fc:b4:67:55:a5:24   (Unknown)
192.168.0.192 24:dc:c3:a1:80:f0   (Unknown)
192.168.0.175 ac:41:6a:26:cd:1f   (Unknown)
192.168.0.173 e8:4c:4a:b4:cc:5c   (Unknown)
192.168.0.184 4e:03:73:ea:b3:b8   (Unknown: locally administered)
192.168.0.186 5c:61:99:7a:64:5d   (Unknown)
192.168.0.103 0c:9d:92:29:4a:a3   ASUSTek COMPUTER INC.
192.168.0.129 62:1e:f2:c4:cf:80   (Unknown: locally administered)
```

Hopefully these names will allow you to identify the machines. In my case the target machine was using a TP-Link wireless card so knowing the router is always 192.168.0.1, I was able to deduce that the target machine IP was 192.168.0.113

NOTE: in the example below I am using SSH so the host and target machine will both require SSH to be installed. Use these commands to install:

```
sudo apt-get install openssh-client
sudo apt-get install openssh-server
```

Now I am able to access the machine via SSH by using the command `ssh <username>@192.168.0.113`. Once connected I am prompted to enter the password for user <username>

To explore the remote file system with Nautilus, I can open my local Nautilus window and under + Other Locations add `ssh://<username>@192.168.0.113`. Once open it will prompt me for the password for user <username>.

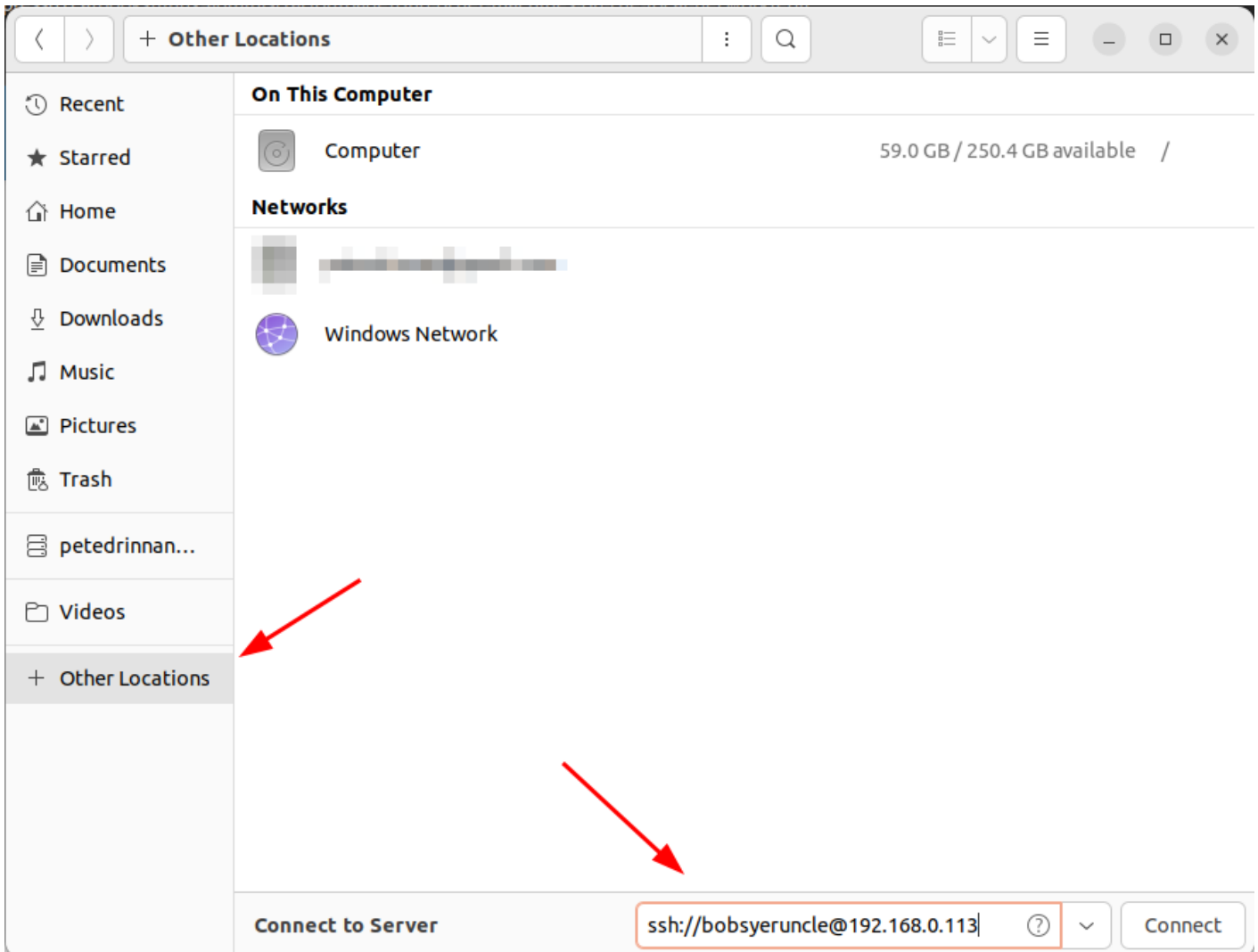

For a more permanent fix, you can add the host to your local `~/.ssh/config` file as such:

```
Host bobsmachine
HostName 192.168.0.113
User bobsyeruncle
```

Now you can go into nautilus and under + Other Locations enter `ssh://bobsmachine`

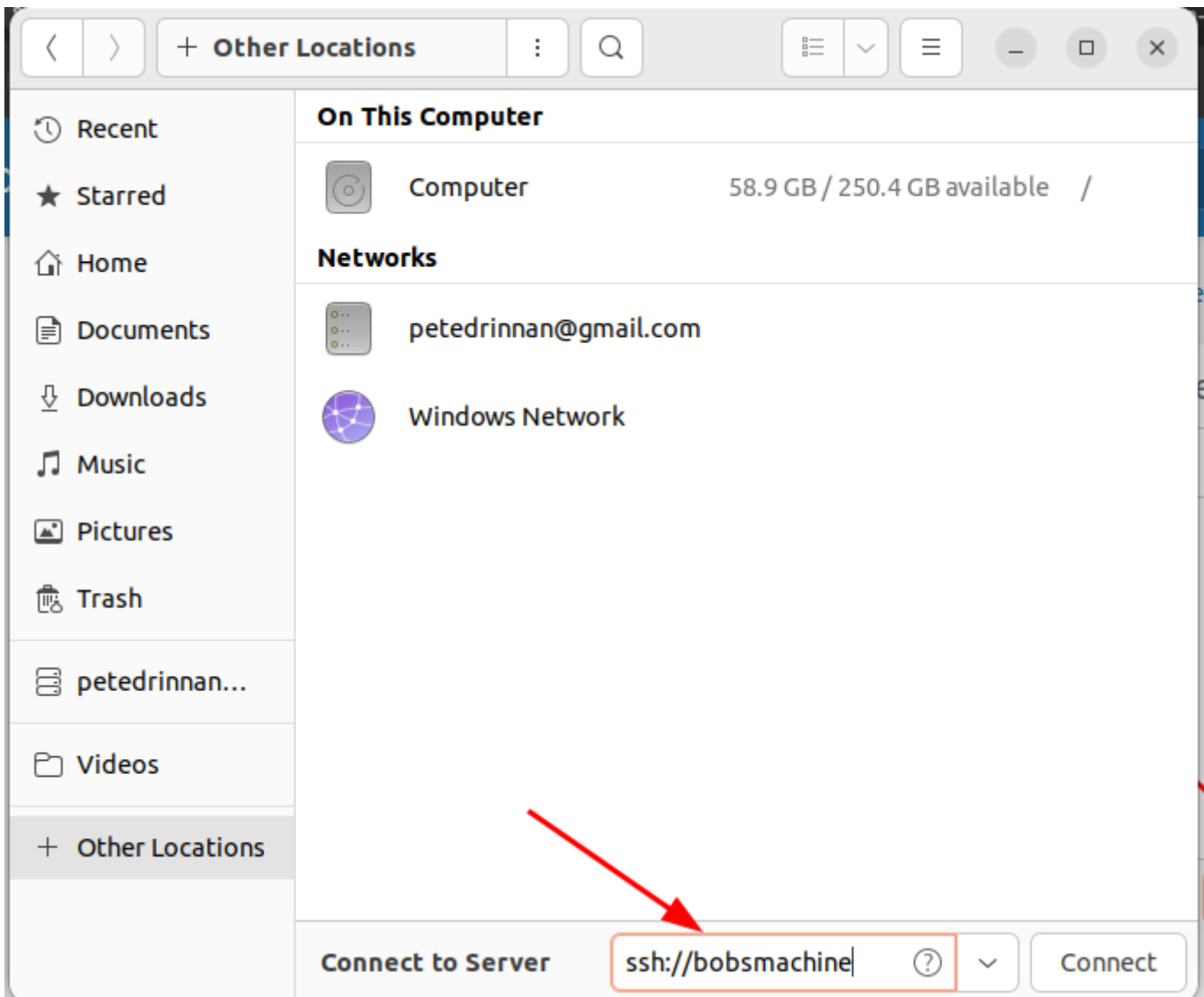

When prompted to enter the username and password, selecting the "Remember forever" option will allow you to login to the remote machine in the future without having to re-enter the password.

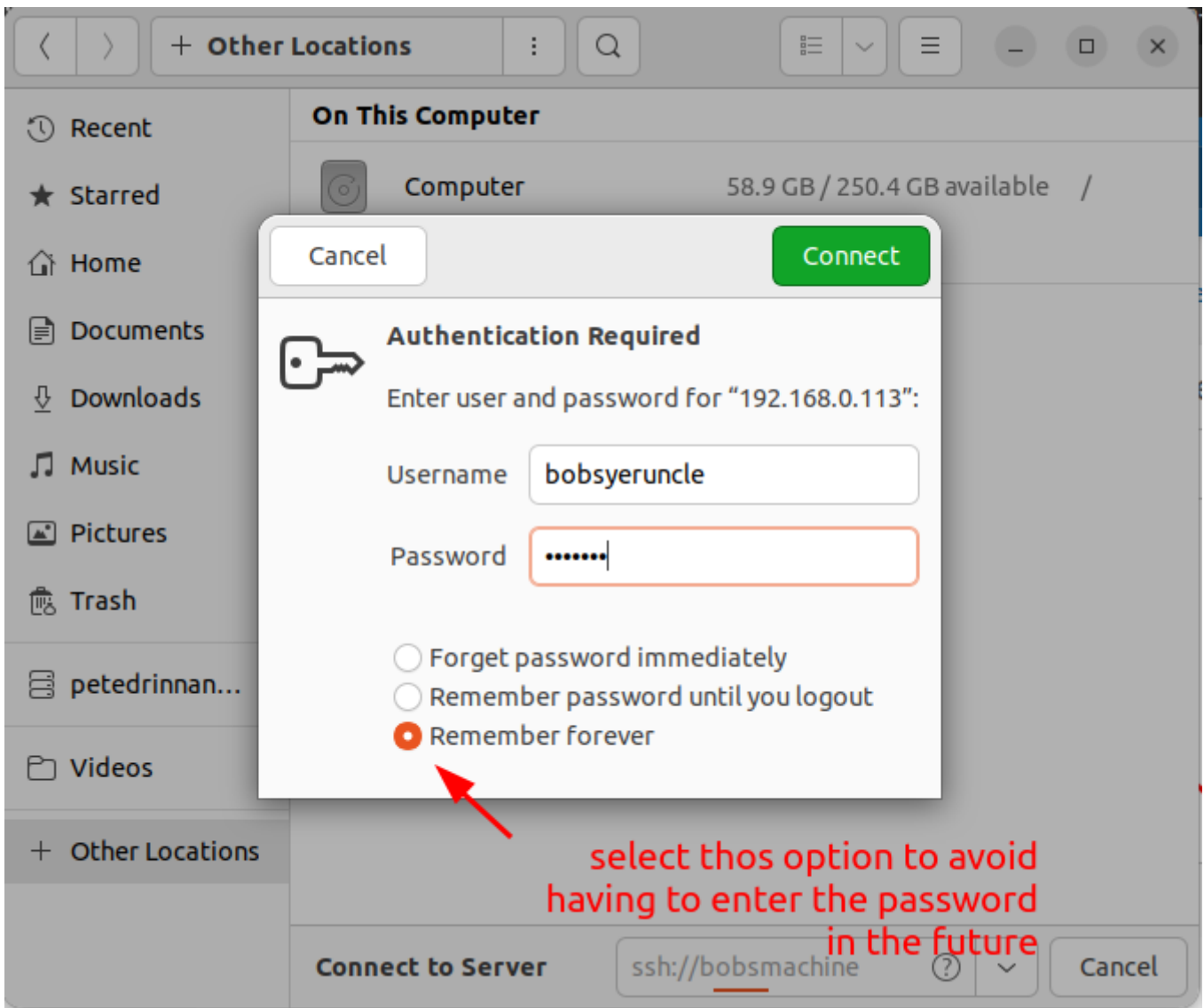

Revision #8

Created 20 January 2024 22:54:27 by peter drinnan

Updated 20 January 2024 23:32:54 by peter drinnan